

Marketing and Advertising Group

3125 South Kolin Avenue • Chicago, IL 60623 • 773-254-3929 • Fax: 773-254-3935

FOR IMMEDIATE RELEASE

Contact:

Lizzie Ephraim, MPE

P: (773) 254-3929

lizzie@mpechicago.com

MPE & Petroncini Make Bag Cutting Easy & Litigation Free

CHICAGO, IL – It's a beautiful sight for coffee lovers; heavy bags of excellent green coffee arrive for processing. Unloading these bags and emptying them can be a costly task in terms of labor and potential worker injury. MPE now offers a solution in partnership with Petroncini Impianti S.p.A. to automate the bag cutting and emptying process; increasing labor efficiency and reducing injury risk. The Petroncini automatic bag opener can empty 900 bags/hour and be controlled by MPE's Plant Control System. Using circular blades opposed to each other that act like scissors, the blades slice the bags in numerous places at low speed ensuring the coffee can be emptied without bean breakage or yield losses.

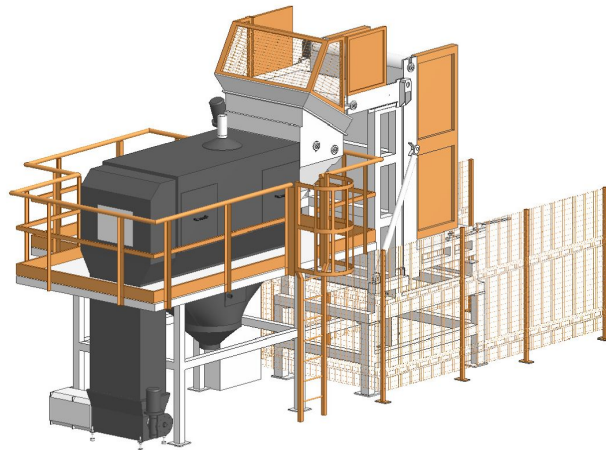

About MPE

MPE is a global leader of coffee processing equipment with a full range of solutions for green coffee and roasted coffee processing. MPE's category leading products such as MPE Coffee Gran-U-Lizer™ and the Chain-Vey® conveyor are used by leading coffee roasting companies throughout the world. Since 1957, the MPE name has been synonymous with high-quality equipment and innovative product designs. For more information contact Modern Process

Marketing and Advertising Group

3125 South Kolin Avenue • Chicago, IL 60623 • 773-254-3929 • Fax: 773-254-3935

Marketing and Advertising Group

3125 South Kolin Avenue • Chicago, IL 60623 • 773-254-3929 • Fax: 773-254-3935

Equipment Corporation at 3125 South Kolin Avenue, Chicago, IL 60623, call 773-254-3929 or visit www.mpechicago.com.

Marketing and Advertising Group

3125 South Kolin Avenue • Chicago, IL 60623 • 773-254-3929 • Fax: 773-254-3935